

# Appendix 4

## Property Information

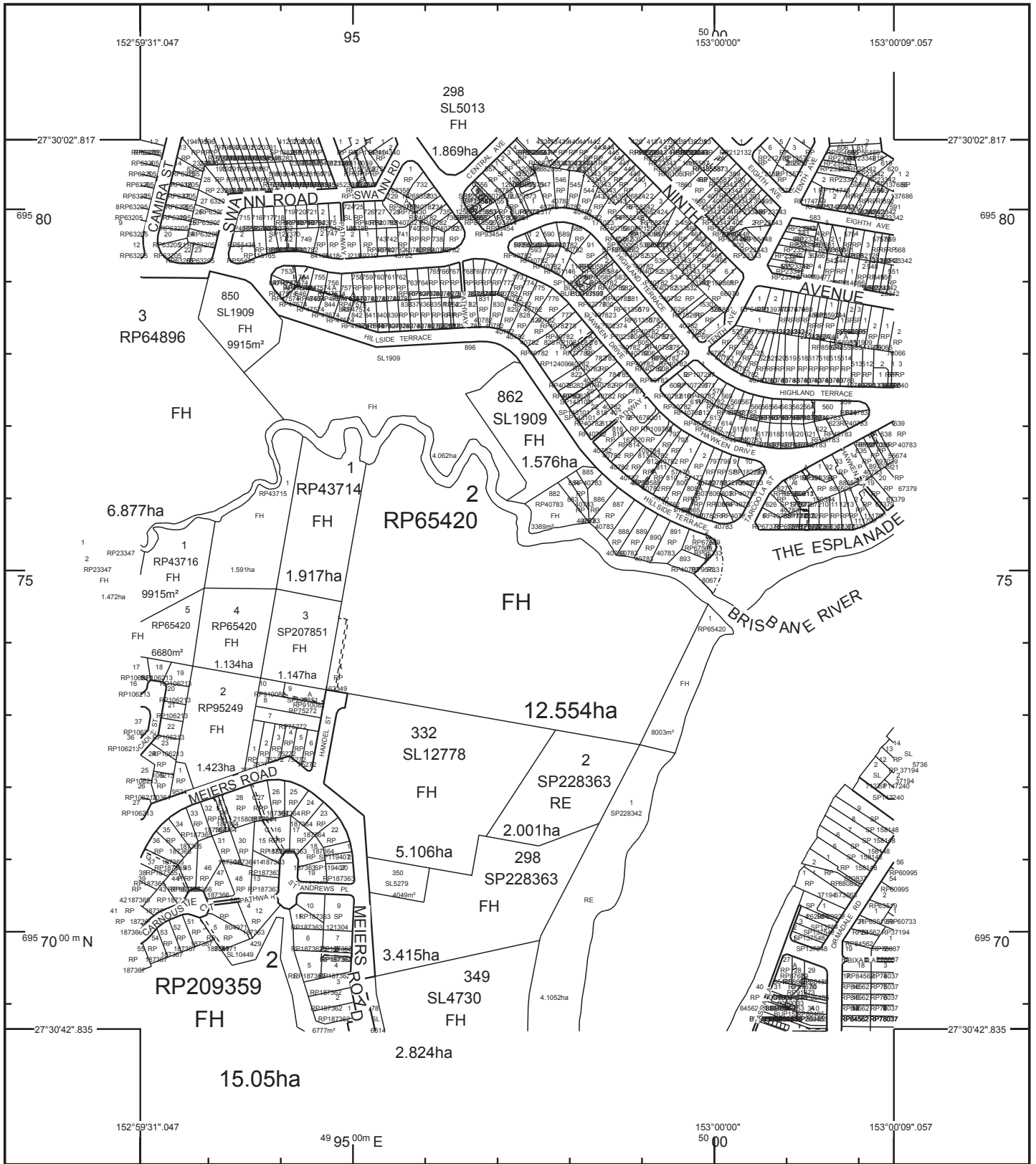

STANDARD MAP NUMBER  
9442-11111



MAP WINDOW POSITION & NEAREST LOCATION

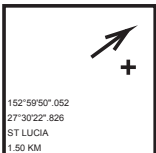

SUBJECT PARCEL DESCRIPTION

DCDB	
Lot/Plan	2/RP65420
Area/Volume	12.554ha
Tenure	FREEHOLD
Local Government	BRISBANE CITY
Locality	ST LUCIA
Parish	INDOOROOPILLY
County	STANLEY
Segment/Parcel	13374/1

CLIENT SERVICE STANDARDS

PRINTED (dd/mm/yyyy)	10/11/2014
DCDB	07/11/2014
Users of the information recorded in this document (the Information) accept all responsibility and risk associated with the use of the Information and should seek independent professional advice in relation to dealings with property.	
Despite Department of Natural Resources and Mines(DNRM)'s best efforts, DNRM makes no representations or warranties in relation to the Information, and, to the extent permitted by law, exclude or limit all warranties relating to correctness, accuracy, reliability, completeness or currency and all liability for any direct, indirect and consequential costs, losses, damages and expenses incurred in any way (including but not limited to that arising from negligence) in connection with any use of or reliance on the Information	
For further information on SmartMap products visit <a href="http://nrw.qld.gov.au/property/mapping/blinmap">http://nrw.qld.gov.au/property/mapping/blinmap</a>	

**SmartMap**

An External Product of  
SmartMap Information Services  
Based upon an extraction from the  
Digital Cadastral Data Base



Queensland  
Government

(c) The State of Queensland,  
(Department of Natural  
Resources and Mines) 2014.



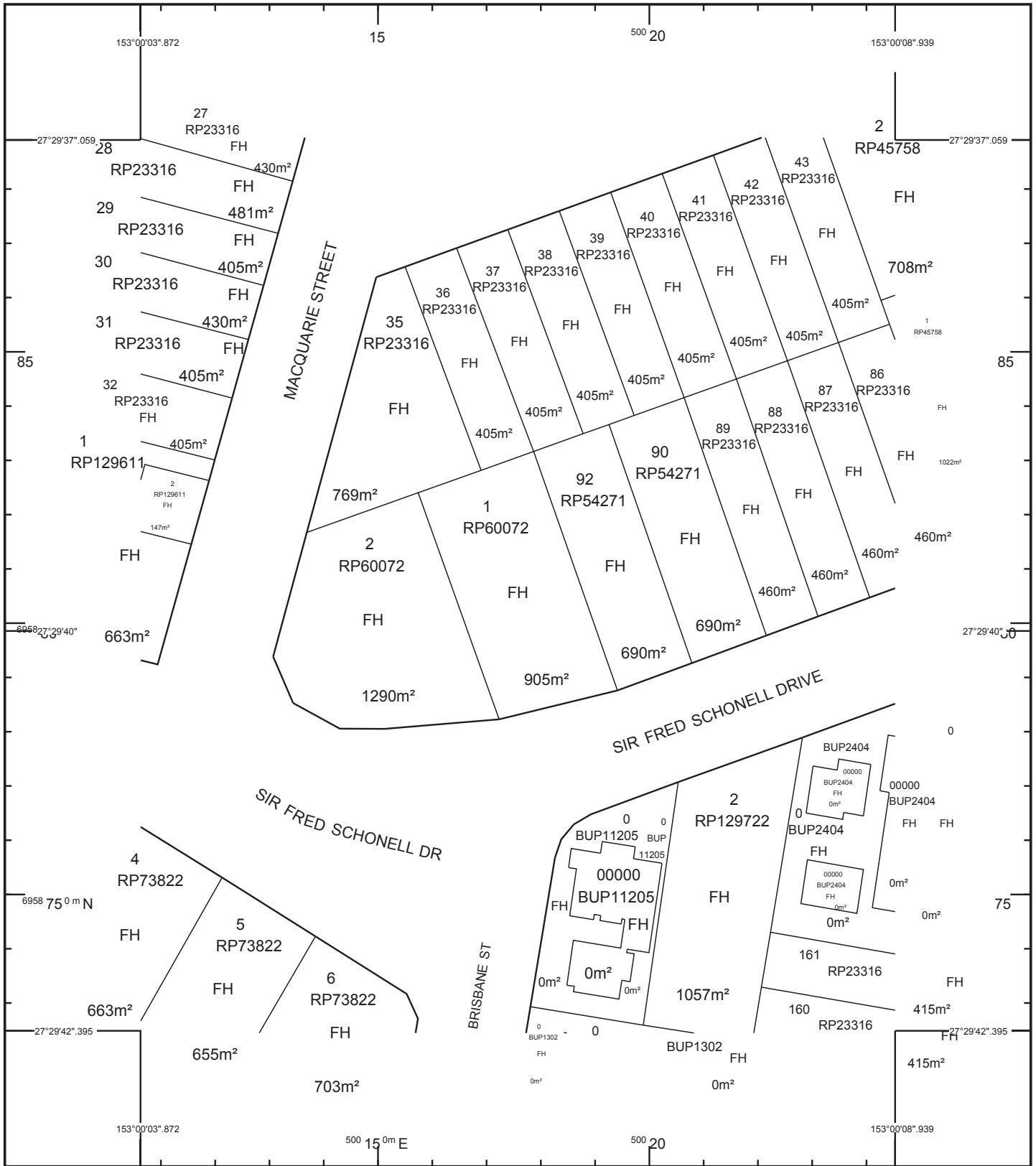

STANDARD MAP NUMBER  
9543-33333



MAP WINDOW POSITION & NEAREST LOCATION

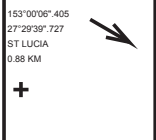

SUBJECT PARCEL DESCRIPTION

DCDB	1/RP60072
Lot/Plan	905m²
Area/Volume	FREEHOLD
Tenure	BRISBANE CITY
Local Government	ST LUCIA
Locality	INDOOROOPILLY
Parish	STANLEY
County	13698/28
Segment/Parcel	

CLIENT SERVICE STANDARDS

PRINTED (dd/mm/yyyy)	10/11/2014
DCDB	07/11/2014
Users of the information recorded in this document (the Information) accept all responsibility and risk associated with the use of the Information and should seek independent professional advice in relation to dealings with property.	
Despite Department of Natural Resources and Mines(DNRM)'s best efforts, DNRM makes no representations or warranties in relation to the Information, and, to the extent permitted by law, exclude or limit all warranties relating to correctness, accuracy, reliability, completeness or currency and all liability for any direct, indirect and consequential costs, losses, damages and expenses incurred in any way (including but not limited to that arising from negligence) in connection with any use of or reliance on the Information	
For further information on SmartMap products visit <a href="http://nrw.qld.gov.au/property/mapping/blinmap">http://nrw.qld.gov.au/property/mapping/blinmap</a>	

**SmartMap**

An External Product of  
SmartMap Information Services  
Based upon an extraction from the  
Digital Cadastral Data Base



(c) The State of Queensland,  
(Department of Natural  
Resources and Mines) 2014.



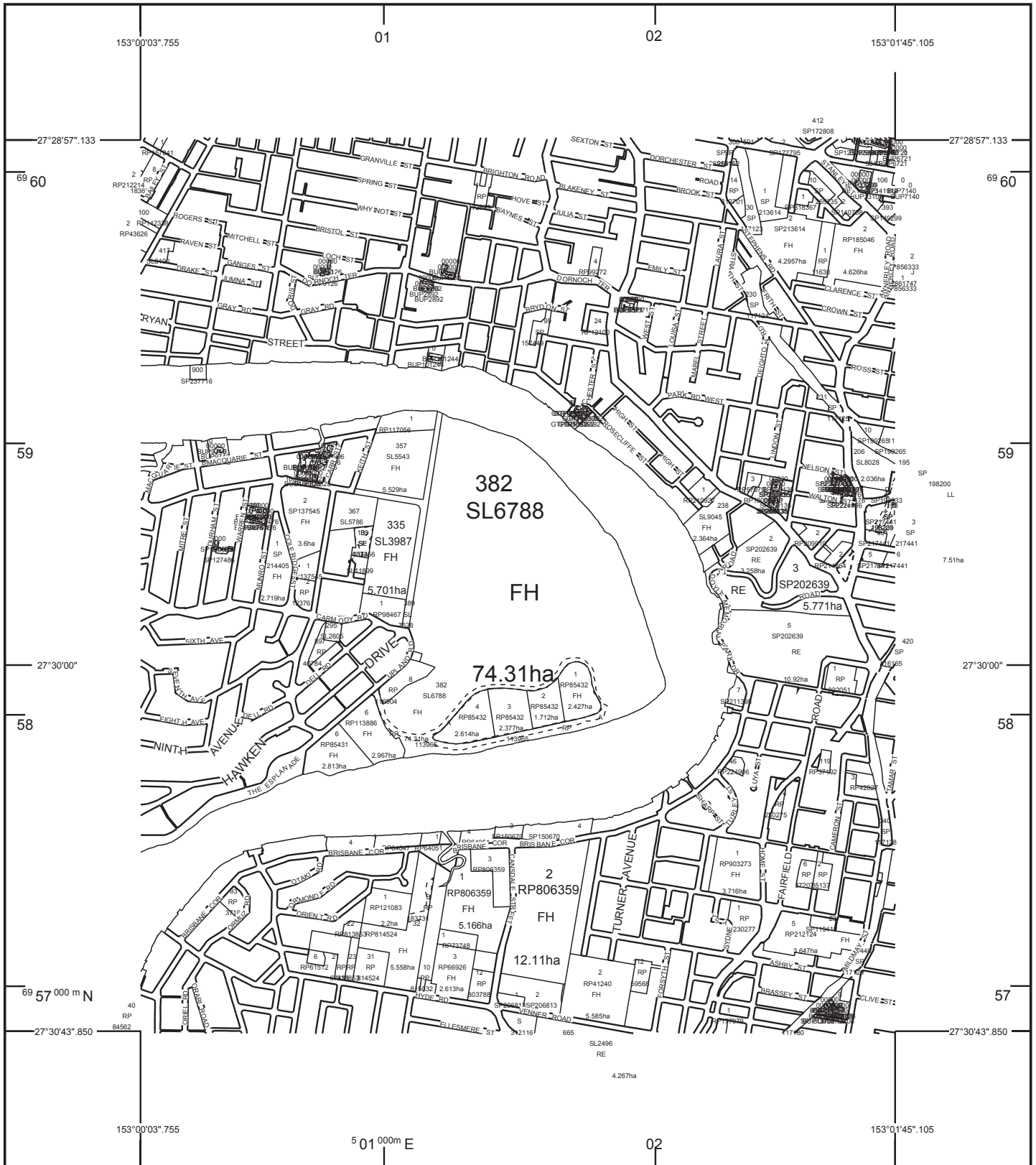

STANDARD MAP NUMBER  
9543-33333



MAP WINDOW POSITION & NEAREST LOCATION

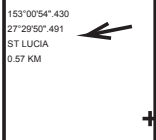

**SUBJECT PARCEL DESCRIPTION**

DCDB	382/SL6788
Lot/Plan	74.31ha
Area/Volume	FREEHOLD
Tenure	BRISBANE CITY
Local Government	ST LUCIA
Locality	INDOOROOPILLY
Parish	STANLEY
County	13350/14
Segment/Parcel	

**CLIENT SERVICE STANDARDS**

PRINTED (dd/mm/yyyy) 18/11/2014

DCDB 17/11/2014 (Lots with an area less than 3000m<sup>2</sup> are not shown)

Users of the information recorded in this document (the Information) accept all responsibility and risk associated with the use of the Information and should seek independent professional advice in relation to dealings with property.

Despite Department of Natural Resources and Mines (DNRM)'s best efforts, DNRM makes no representations or warranties in relation to the Information, and, to the extent permitted by law, exclude or limit all warranties relating to correctness, accuracy, reliability, completeness or currency and all liability for any direct, indirect and consequential costs, losses, damages and expenses incurred in any way (including but not limited to that arising from negligence) in connection with any use of or reliance on the Information

For further information on SmartMap products visit <http://nrw.qld.gov.au/property/mapping/blinmap>

**SmartMap**

An External Product of  
SmartMap Information Services  
Based upon an extraction from the  
Digital Cadastral Data Base



**Queensland  
Government**

(c) The State of Queensland,  
(Department of Natural  
Resources and Mines) 2014.



# CURRENT TITLE SEARCH

DEPT OF NATURAL RESOURCES AND MINES, QUEENSLAND

Request No: 19906672

Search Date: 01/12/2014 14:39

Title Reference: 12543074

Date Created: 26/02/1951

Previous Title: 11671147

## REGISTERED OWNER

THE UNIVERSITY OF QUEENSLAND

## ESTATE AND LAND

Estate in Fee Simple

LOT 1 REGISTERED PLAN 60072  
County of STANLEY Parish of INDOOROOPIILLY  
Local Government: BRISBANE CITY

## EASEMENTS, ENCUMBRANCES AND INTERESTS

1. Rights and interests reserved to the Crown by  
Deed of Grant No. 19506143 (POR 10)

ADMINISTRATIVE ADVICES - NIL

UNREGISTERED DEALINGS - NIL

CERTIFICATE OF TITLE ISSUED - Yes

Certificate No. 1

\*\* End of Current Title Search \*\*

COPYRIGHT THE STATE OF QUEENSLAND (DEPT OF NATURAL RESOURCES AND MINES) [2014]  
Requested By: SMIS .

# CURRENT TITLE SEARCH

DEPT OF NATURAL RESOURCES AND MINES, QUEENSLAND

Request No: 19906682

Search Date: 01/12/2014 14:39

Title Reference: 12540086

Date Created: 09/02/1951

Previous Title: 11800080

## REGISTERED OWNER

THE UNIVERSITY OF QUEENSLAND

## ESTATE AND LAND

Estate in Fee Simple

LOT 35	REGISTERED PLAN 23316	
	County of STANLEY	Parish of INDOOROOPILLY
	Local Government: BRISBANE CITY	
LOT 36	REGISTERED PLAN 23316	
	County of STANLEY	Parish of INDOOROOPILLY
	Local Government: BRISBANE CITY	
LOT 2	REGISTERED PLAN 60072	
	County of STANLEY	Parish of INDOOROOPILLY
	Local Government: BRISBANE CITY	

## EASEMENTS, ENCUMBRANCES AND INTERESTS

1. Rights and interests reserved to the Crown by  
Deed of Grant No. 19506143 (POR 10)

ADMINISTRATIVE ADVICES - NIL

UNREGISTERED DEALINGS - NIL

CERTIFICATE OF TITLE ISSUED - Yes

Certificate No. 1

\*\* End of Current Title Search \*\*

COPYRIGHT THE STATE OF QUEENSLAND (DEPT OF NATURAL RESOURCES AND MINES) [2014]  
Requested By: SMIS .

# CURRENT TITLE SEARCH

DEPT OF NATURAL RESOURCES AND MINES, QUEENSLAND

Request No: 19906687

Search Date: 01/12/2014 14:39

Title Reference: 12540086

Date Created: 09/02/1951

Previous Title: 11800080

## REGISTERED OWNER

THE UNIVERSITY OF QUEENSLAND

## ESTATE AND LAND

Estate in Fee Simple

LOT 35	REGISTERED PLAN 23316	
	County of STANLEY	Parish of INDOOROOPILLY
	Local Government: BRISBANE CITY	
LOT 36	REGISTERED PLAN 23316	
	County of STANLEY	Parish of INDOOROOPILLY
	Local Government: BRISBANE CITY	
LOT 2	REGISTERED PLAN 60072	
	County of STANLEY	Parish of INDOOROOPILLY
	Local Government: BRISBANE CITY	

## EASEMENTS, ENCUMBRANCES AND INTERESTS

1. Rights and interests reserved to the Crown by  
Deed of Grant No. 19506143 (POR 10)

ADMINISTRATIVE ADVICES - NIL

UNREGISTERED DEALINGS - NIL

CERTIFICATE OF TITLE ISSUED - Yes

Certificate No. 1

\*\* End of Current Title Search \*\*

COPYRIGHT THE STATE OF QUEENSLAND (DEPT OF NATURAL RESOURCES AND MINES) [2014]  
Requested By: SMIS .

# CURRENT TITLE SEARCH

DEPT OF NATURAL RESOURCES AND MINES, QUEENSLAND

Request No: 19906695

Search Date: 01/12/2014 14:40

Title Reference: 12540086

Date Created: 09/02/1951

Previous Title: 11800080

## REGISTERED OWNER

THE UNIVERSITY OF QUEENSLAND

## ESTATE AND LAND

Estate in Fee Simple

LOT 35	REGISTERED PLAN 23316	
	County of STANLEY	Parish of INDOOROOPILLY
	Local Government: BRISBANE CITY	
LOT 36	REGISTERED PLAN 23316	
	County of STANLEY	Parish of INDOOROOPILLY
	Local Government: BRISBANE CITY	
LOT 2	REGISTERED PLAN 60072	
	County of STANLEY	Parish of INDOOROOPILLY
	Local Government: BRISBANE CITY	

## EASEMENTS, ENCUMBRANCES AND INTERESTS

1. Rights and interests reserved to the Crown by  
Deed of Grant No. 19506143 (POR 10)

ADMINISTRATIVE ADVICES - NIL

UNREGISTERED DEALINGS - NIL

CERTIFICATE OF TITLE ISSUED - Yes

Certificate No. 1

\*\* End of Current Title Search \*\*

COPYRIGHT THE STATE OF QUEENSLAND (DEPT OF NATURAL RESOURCES AND MINES) [2014]  
Requested By: SMIS .



# CURRENT TITLE SEARCH

DEPT OF NATURAL RESOURCES AND MINES, QUEENSLAND

Request No: 19906701

Search Date: 01/12/2014 14:40

Title Reference: 12446147

Date Created: 02/08/1949

Previous Title: 12416062

## REGISTERED OWNER

Dealing No: 714503240 07/06/2012

THE UNIVERSITY OF QUEENSLAND A.B.N. 63 942 912 684

## ESTATE AND LAND

Estate in Fee Simple

LOT 37 REGISTERED PLAN 23316

County of STANLEY

Parish of INDOOROOPIILLY

Local Government: BRISBANE CITY

## EASEMENTS, ENCUMBRANCES AND INTERESTS

1. Rights and interests reserved to the Crown by  
Deed of Grant No. 19506143 (POR 10)

ADMINISTRATIVE ADVICES - NIL

UNREGISTERED DEALINGS - NIL

CERTIFICATE OF TITLE ISSUED - No

\*\* End of Current Title Search \*\*

COPYRIGHT THE STATE OF QUEENSLAND (DEPT OF NATURAL RESOURCES AND MINES) [2014]

Requested By: SMIS .

# CURRENT TITLE SEARCH

DEPT OF NATURAL RESOURCES AND MINES, QUEENSLAND

Request No: 19906748

Search Date: 01/12/2014 14:43

Title Reference: 12445220

Date Created: 27/07/1949

Previous Title: 12416062

## REGISTERED OWNER

Dealing No: 714638804 24/08/2012

THE UNIVERSITY OF QUEENSLAND

## ESTATE AND LAND

Estate in Fee Simple

LOT 38	REGISTERED PLAN 23316	
	County of STANLEY	Parish of INDOOROOPILLY
	Local Government: BRISBANE CITY	
LOT 39	REGISTERED PLAN 23316	
	County of STANLEY	Parish of INDOOROOPILLY
	Local Government: BRISBANE CITY	

## EASEMENTS, ENCUMBRANCES AND INTERESTS

1. Rights and interests reserved to the Crown by  
Deed of Grant No. 19506143 (POR 10)

ADMINISTRATIVE ADVICES - NIL

UNREGISTERED DEALINGS - NIL

CERTIFICATE OF TITLE ISSUED - No

\*\* End of Current Title Search \*\*

COPYRIGHT THE STATE OF QUEENSLAND (DEPT OF NATURAL RESOURCES AND MINES) [2014]  
Requested By: SMIS .

# CURRENT TITLE SEARCH

DEPT OF NATURAL RESOURCES AND MINES, QUEENSLAND

Request No: 19906759

Search Date: 01/12/2014 14:44

Title Reference: 12445220

Date Created: 27/07/1949

Previous Title: 12416062

## REGISTERED OWNER

Dealing No: 714638804 24/08/2012

THE UNIVERSITY OF QUEENSLAND

## ESTATE AND LAND

Estate in Fee Simple

LOT 38	REGISTERED PLAN 23316	
	County of STANLEY	Parish of INDOOROOPILLY
	Local Government: BRISBANE CITY	
LOT 39	REGISTERED PLAN 23316	
	County of STANLEY	Parish of INDOOROOPILLY
	Local Government: BRISBANE CITY	

## EASEMENTS, ENCUMBRANCES AND INTERESTS

1. Rights and interests reserved to the Crown by  
Deed of Grant No. 19506143 (POR 10)

ADMINISTRATIVE ADVICES - NIL

UNREGISTERED DEALINGS - NIL

CERTIFICATE OF TITLE ISSUED - No

\*\* End of Current Title Search \*\*

COPYRIGHT THE STATE OF QUEENSLAND (DEPT OF NATURAL RESOURCES AND MINES) [2014]  
Requested By: SMIS .

# CURRENT TITLE SEARCH

DEPT OF NATURAL RESOURCES AND MINES, QUEENSLAND

Request No: 19906766

Search Date: 01/12/2014 14:44

Title Reference: 12012192

Date Created: 23/11/1937

Previous Title: 10847018

11629142

## REGISTERED OWNER

Dealing No: 713816422 19/04/2011

THE UNIVERSITY OF QUEENSLAND

## ESTATE AND LAND

Estate in Fee Simple

LOT 90 REGISTERED PLAN 54271

County of STANLEY

Parish of INDOOROOPIILLY

Local Government: BRISBANE CITY

## EASEMENTS, ENCUMBRANCES AND INTERESTS

1. Rights and interests reserved to the Crown by  
Deed of Grant No. 19506143 (POR 10)

ADMINISTRATIVE ADVICES - NIL

UNREGISTERED DEALINGS - NIL

CERTIFICATE OF TITLE ISSUED - No

\*\* End of Current Title Search \*\*

COPYRIGHT THE STATE OF QUEENSLAND (DEPT OF NATURAL RESOURCES AND MINES) [2014]

Requested By: SMIS .

# CURRENT TITLE SEARCH

DEPT OF NATURAL RESOURCES AND MINES, QUEENSLAND

Request No: 19906771

Search Date: 01/12/2014 14:45

Title Reference: 12071095

Date Created: 08/05/1939

Previous Title: 10847018

10975104

## REGISTERED OWNER

Dealing No: 700977923 01/11/1995

THE UNIVERSITY OF QUEENSLAND

## ESTATE AND LAND

Estate in Fee Simple

LOT 92 REGISTERED PLAN 54271

County of STANLEY

Parish of INDOOROOPIILLY

Local Government: BRISBANE CITY

## EASEMENTS, ENCUMBRANCES AND INTERESTS

1. Rights and interests reserved to the Crown by  
Deed of Grant No. 19506143 (POR 10)

ADMINISTRATIVE ADVICES - NIL

UNREGISTERED DEALINGS - NIL

CERTIFICATE OF TITLE ISSUED - No

\*\* End of Current Title Search \*\*

COPYRIGHT THE STATE OF QUEENSLAND (DEPT OF NATURAL RESOURCES AND MINES) [2014]

Requested By: SMIS .

# CURRENT TITLE SEARCH

DEPT OF NATURAL RESOURCES AND MINES, QUEENSLAND

Request No: 19900842

Search Date: 01/12/2014 09:24

Title Reference: 50426061

Date Created: 30/01/2003

Previous Title: 50176279

50176280

50176281

50176282

50176283

## REGISTERED OWNER

Dealing No: 706214275 18/12/2002

THE UNIVERSITY OF QUEENSLAND

## ESTATE AND LAND

Estate in Fee Simple

LOT 1

SURVEY PLAN 150763

County of STANLEY

Parish of INDOOROOPIILLY

Local Government: BRISBANE CITY

## EASEMENTS, ENCUMBRANCES AND INTERESTS

1. Rights and interests reserved to the Crown by  
Deed of Grant No. 19509228 (POR 19)

ADMINISTRATIVE ADVICES - NIL

UNREGISTERED DEALINGS - NIL

CERTIFICATE OF TITLE ISSUED - No

\*\* End of Current Title Search \*\*

COPYRIGHT THE STATE OF QUEENSLAND (DEPT OF NATURAL RESOURCES AND MINES) [2014]

Requested By: SMIS .

# CURRENT TITLE SEARCH

DEPT OF NATURAL RESOURCES AND MINES, QUEENSLAND

Request No: 19900773

Search Date: 01/12/2014 09:22

Title Reference: 12389147

Date Created: 06/04/1948

Previous Title: 12230051

## REGISTERED OWNER

THE UNIVERSITY OF QUEENSLAND

## ESTATE AND LAND

Estate in Fee Simple

LOT 1 REGISTERED PLAN 63440

County of STANLEY

Parish of INDOOROOPIILLY

Local Government: BRISBANE CITY

## EASEMENTS, ENCUMBRANCES AND INTERESTS

1. Rights and interests reserved to the Crown by  
Deed of Grant No. 19509228 (POR 19)

ADMINISTRATIVE ADVICES - NIL

UNREGISTERED DEALINGS - NIL

CERTIFICATE OF TITLE ISSUED - Yes

Certificate No. 1

\*\* End of Current Title Search \*\*

COPYRIGHT THE STATE OF QUEENSLAND (DEPT OF NATURAL RESOURCES AND MINES) [2014]  
Requested By: SMIS .

# CURRENT TITLE SEARCH

DEPT OF NATURAL RESOURCES AND MINES, QUEENSLAND

Request No: 19900770

Search Date: 01/12/2014 09:21

Title Reference: 16173247

Date Created: 15/09/1981

Previous Title: 13849235

13849236

## REGISTERED OWNER

THE UNIVERSITY OF QUEENSLAND

## ESTATE AND LAND

Estate in Fee Simple

LOT 2 REGISTERED PLAN 63440

County of STANLEY

Parish of INDOOROOPIILLY

Local Government: BRISBANE CITY

## EASEMENTS, ENCUMBRANCES AND INTERESTS

1. Rights and interests reserved to the Crown by  
Deed of Grant No. 19509228 (POR 19)

ADMINISTRATIVE ADVICES - NIL

UNREGISTERED DEALINGS - NIL

CERTIFICATE OF TITLE ISSUED - Yes

Certificate No. 1

\*\* End of Current Title Search \*\*

COPYRIGHT THE STATE OF QUEENSLAND (DEPT OF NATURAL RESOURCES AND MINES) [2014]

Requested By: SMIS .



# CURRENT TITLE SEARCH

DEPT OF NATURAL RESOURCES AND MINES, QUEENSLAND

Request No: 19900980

Search Date: 01/12/2014 09:31

Title Reference: 11824167

Date Created: 29/12/1930

Previous Title: 11706141

## REGISTERED OWNER

THE UNIVERSITY OF QUEENSLAND

## ESTATE AND LAND

Estate in Fee Simple

LOT 263 REGISTERED PLAN 40785

County of STANLEY

Parish of INDOOROOPIILLY

Local Government: BRISBANE CITY

## EASEMENTS, ENCUMBRANCES AND INTERESTS

1. Rights and interests reserved to the Crown by  
Deed of Grant No. 11601058 (POR 18)  
Deed of Grant No. 19509228 (POR 19)

ADMINISTRATIVE ADVICES - NIL

UNREGISTERED DEALINGS - NIL

CERTIFICATE OF TITLE ISSUED - Yes

Certificate No. 1

\*\* End of Current Title Search \*\*

COPYRIGHT THE STATE OF QUEENSLAND (DEPT OF NATURAL RESOURCES AND MINES) [2014]

Requested By: SMIS .

# CURRENT TITLE SEARCH

DEPT OF NATURAL RESOURCES AND MINES, QUEENSLAND

Request No: 19900697

Search Date: 01/12/2014 09:17

Title Reference: 12345064

Date Created: 10/07/1947

Previous Title: 12307086

## REGISTERED OWNER

THE UNIVERSITY OF QUEENSLAND

## ESTATE AND LAND

Estate in Fee Simple

LOT 264 REGISTERED PLAN 40785

County of STANLEY

Parish of INDOOROOPIILLY

Local Government: BRISBANE CITY

## EASEMENTS, ENCUMBRANCES AND INTERESTS

1. Rights and interests reserved to the Crown by  
Deed of Grant No. 11601058 (POR 18)  
Deed of Grant No. 19509228 (POR 19)

ADMINISTRATIVE ADVICES - NIL

UNREGISTERED DEALINGS - NIL

CERTIFICATE OF TITLE ISSUED - Yes

Certificate No. 1

\*\* End of Current Title Search \*\*

COPYRIGHT THE STATE OF QUEENSLAND (DEPT OF NATURAL RESOURCES AND MINES) [2014]

Requested By: SMIS .

# CURRENT TITLE SEARCH

DEPT OF NATURAL RESOURCES AND MINES, QUEENSLAND

Request No: 19900712

Search Date: 01/12/2014 09:18

Title Reference: 12345063

Date Created: 10/07/1947

Previous Title: 12307086

## REGISTERED OWNER

Dealing No: 713904625 14/06/2011

THE UNIVERSITY OF QUEENSLAND

## ESTATE AND LAND

Estate in Fee Simple

LOT 265 REGISTERED PLAN 40785

County of STANLEY

Parish of INDOOROOPIILLY

Local Government: BRISBANE CITY

## EASEMENTS, ENCUMBRANCES AND INTERESTS

1. Rights and interests reserved to the Crown by

Deed of Grant No. 11601058 (POR 18)

Deed of Grant No. 19509228 (POR 19)

ADMINISTRATIVE ADVICES - NIL

UNREGISTERED DEALINGS - NIL

CERTIFICATE OF TITLE ISSUED - No

\*\* End of Current Title Search \*\*

COPYRIGHT THE STATE OF QUEENSLAND (DEPT OF NATURAL RESOURCES AND MINES) [2014]

Requested By: SMIS .

# CURRENT TITLE SEARCH

DEPT OF NATURAL RESOURCES AND MINES, QUEENSLAND

Request No: 19900715

Search Date: 01/12/2014 09:18

Title Reference: 14122149

Date Created: 16/01/1968

Previous Title: 11742188

## REGISTERED OWNER

Dealing No: 713904619 14/06/2011

THE UNIVERSITY OF QUEENSLAND

## ESTATE AND LAND

Estate in Fee Simple

LOT 266 REGISTERED PLAN 40785

County of STANLEY

Parish of INDOOROOPIILLY

Local Government: BRISBANE CITY

## EASEMENTS, ENCUMBRANCES AND INTERESTS

1. Rights and interests reserved to the Crown by

Deed of Grant No. 11601058 (POR 18)

Deed of Grant No. 19509228 (POR 19)

ADMINISTRATIVE ADVICES - NIL

UNREGISTERED DEALINGS - NIL

CERTIFICATE OF TITLE ISSUED - No

\*\* End of Current Title Search \*\*

COPYRIGHT THE STATE OF QUEENSLAND (DEPT OF NATURAL RESOURCES AND MINES) [2014]

Requested By: SMIS .

# CURRENT TITLE SEARCH

DEPT OF NATURAL RESOURCES AND MINES, QUEENSLAND

Request No: 19900722

Search Date: 01/12/2014 09:18

Title Reference: 11706125

Date Created: 21/06/1927

Previous Title: 11669239

## REGISTERED OWNER

THE UNIVERSITY OF QUEENSLAND

## ESTATE AND LAND

Estate in Fee Simple

LOT 267 REGISTERED PLAN 40785

County of STANLEY

Parish of INDOOROOPIILLY

Local Government: BRISBANE CITY

## EASEMENTS, ENCUMBRANCES AND INTERESTS

1. Rights and interests reserved to the Crown by  
Deed of Grant No. 11601058 (POR 18)  
Deed of Grant No. 19509228 (POR 19)

ADMINISTRATIVE ADVICES - NIL

UNREGISTERED DEALINGS - NIL

CERTIFICATE OF TITLE ISSUED - Yes

Certificate No. 1

Corrections have occurred - Refer to Historical Search

\*\* End of Current Title Search \*\*

COPYRIGHT THE STATE OF QUEENSLAND (DEPT OF NATURAL RESOURCES AND MINES) [2014]

Requested By: SMIS .

# CURRENT TITLE SEARCH

DEPT OF NATURAL RESOURCES AND MINES, QUEENSLAND

Request No: 19900729

Search Date: 01/12/2014 09:19

Title Reference: 11706212

Date Created: 23/06/1927

Previous Title: 11669239

## REGISTERED OWNER

THE UNIVERSITY OF QUEENSLAND

## ESTATE AND LAND

Estate in Fee Simple

LOT 268 REGISTERED PLAN 40785

County of STANLEY

Parish of INDOOROOPIILLY

Local Government: BRISBANE CITY

## EASEMENTS, ENCUMBRANCES AND INTERESTS

1. Rights and interests reserved to the Crown by  
Deed of Grant No. 11601058 (POR 18)  
Deed of Grant No. 19509228 (POR 19)

ADMINISTRATIVE ADVICES - NIL

UNREGISTERED DEALINGS - NIL

CERTIFICATE OF TITLE ISSUED - Yes

Certificate No. 1

\*\* End of Current Title Search \*\*

COPYRIGHT THE STATE OF QUEENSLAND (DEPT OF NATURAL RESOURCES AND MINES) [2014]

Requested By: SMIS .

# CURRENT TITLE SEARCH

DEPT OF NATURAL RESOURCES AND MINES, QUEENSLAND

Request No: 19900738

Search Date: 01/12/2014 09:19

Title Reference: 12713205

Date Created: 02/01/1953

Previous Title: 11943230

## REGISTERED OWNER

THE UNIVERSITY OF QUEENSLAND

## ESTATE AND LAND

Estate in Fee Simple

LOT 269 REGISTERED PLAN 40785

County of STANLEY

Parish of INDOOROOPILLY

Local Government: BRISBANE CITY

## EASEMENTS, ENCUMBRANCES AND INTERESTS

1. Rights and interests reserved to the Crown by  
Deed of Grant No. 19509228 (POR 19)

ADMINISTRATIVE ADVICES - NIL

UNREGISTERED DEALINGS - NIL

CERTIFICATE OF TITLE ISSUED - Yes

Certificate No. 1

\*\* End of Current Title Search \*\*

COPYRIGHT THE STATE OF QUEENSLAND (DEPT OF NATURAL RESOURCES AND MINES) [2014]  
Requested By: SMIS .

# CURRENT TITLE SEARCH

DEPT OF NATURAL RESOURCES AND MINES, QUEENSLAND

Request No: 19900753

Search Date: 01/12/2014 09:20

Title Reference: 12368242

Date Created: 14/11/1947

Previous Title: 11943230

## REGISTERED OWNER

Dealing No: 700694476 09/06/1995

THE UNIVERSITY OF QUEENSLAND

## ESTATE AND LAND

Estate in Fee Simple

LOT 270 REGISTERED PLAN 40784

County of STANLEY

Parish of INDOOROOPIILLY

Local Government: BRISBANE CITY

## EASEMENTS, ENCUMBRANCES AND INTERESTS

1. Rights and interests reserved to the Crown by  
Deed of Grant No. 19509228 (POR 19)

ADMINISTRATIVE ADVICES - NIL

UNREGISTERED DEALINGS - NIL

CERTIFICATE OF TITLE ISSUED - No

\*\* End of Current Title Search \*\*

COPYRIGHT THE STATE OF QUEENSLAND (DEPT OF NATURAL RESOURCES AND MINES) [2014]  
Requested By: SMIS .



# CURRENT TITLE SEARCH

DEPT OF NATURAL RESOURCES AND MINES, QUEENSLAND

Request No: 19900767

Search Date: 01/12/2014 09:21

Title Reference: 15133027

Date Created: 16/04/1974

Previous Title: 14589214  
14589215  
14589216  
14589217  
14589218

## REGISTERED OWNER

THE UNIVERSITY OF QUEENSLAND

## ESTATE AND LAND

Estate in Fee Simple

LOT 271 REGISTERED PLAN 40784  
County of STANLEY Parish of INDOOROOPILLY  
Local Government: BRISBANE CITY

## EASEMENTS, ENCUMBRANCES AND INTERESTS

1. Rights and interests reserved to the Crown by  
Deed of Grant No. 19509228 (POR 19)

ADMINISTRATIVE ADVICES - NIL

UNREGISTERED DEALINGS - NIL

CERTIFICATE OF TITLE ISSUED - Yes

Certificate No. 1

\*\* End of Current Title Search \*\*

COPYRIGHT THE STATE OF QUEENSLAND (DEPT OF NATURAL RESOURCES AND MINES) [2014]  
Requested By: SMIS .

# CURRENT TITLE SEARCH

DEPT OF NATURAL RESOURCES AND MINES, QUEENSLAND

Request No: 19900787

Search Date: 01/12/2014 09:22

Title Reference: 12190206

Date Created: 18/01/1943

Previous Title: 10886020

## REGISTERED OWNER

Dealing No: 713485176 27/09/2010

THE UNIVERSITY OF QUEENSLAND

## ESTATE AND LAND

Estate in Fee Simple

LOT 308 REGISTERED PLAN 40784

County of STANLEY

Parish of INDOOROOPIILLY

Local Government: BRISBANE CITY

## EASEMENTS, ENCUMBRANCES AND INTERESTS

1. Rights and interests reserved to the Crown by  
Deed of Grant No. 19509228 (POR 19)

ADMINISTRATIVE ADVICES - NIL

UNREGISTERED DEALINGS - NIL

CERTIFICATE OF TITLE ISSUED - No

\*\* End of Current Title Search \*\*

COPYRIGHT THE STATE OF QUEENSLAND (DEPT OF NATURAL RESOURCES AND MINES) [2014]

Requested By: SMIS .

# CURRENT TITLE SEARCH

DEPT OF NATURAL RESOURCES AND MINES, QUEENSLAND

Request No: 19900793

Search Date: 01/12/2014 09:22

Title Reference: 11629143

Date Created: 28/07/1925

Previous Title: 10886020

## REGISTERED OWNER

Dealing No: 713534295 25/10/2010

THE UNIVERSITY OF QUEENSLAND

## ESTATE AND LAND

Estate in Fee Simple

LOT 309 REGISTERED PLAN 40784

County of STANLEY

Parish of INDOOROOPIILLY

Local Government: BRISBANE CITY

## EASEMENTS, ENCUMBRANCES AND INTERESTS

1. Rights and interests reserved to the Crown by  
Deed of Grant No. 19509228 (POR 19)

ADMINISTRATIVE ADVICES - NIL

UNREGISTERED DEALINGS - NIL

CERTIFICATE OF TITLE ISSUED - No

\*\* End of Current Title Search \*\*

COPYRIGHT THE STATE OF QUEENSLAND (DEPT OF NATURAL RESOURCES AND MINES) [2014]  
Requested By: SMIS .

# CURRENT TITLE SEARCH

DEPT OF NATURAL RESOURCES AND MINES, QUEENSLAND

Request No: 19900796

Search Date: 01/12/2014 09:23

Title Reference: 12380010

Date Created: 06/02/1948

Previous Title: 11880044

## REGISTERED OWNER

THE UNIVERSITY OF QUEENSLAND

## ESTATE AND LAND

Estate in Fee Simple

LOT 310 REGISTERED PLAN 40784

County of STANLEY

Parish of INDOOROOPIILLY

Local Government: BRISBANE CITY

## EASEMENTS, ENCUMBRANCES AND INTERESTS

1. Rights and interests reserved to the Crown by  
Deed of Grant No. 19509228 (POR 19)

ADMINISTRATIVE ADVICES - NIL

UNREGISTERED DEALINGS - NIL

CERTIFICATE OF TITLE ISSUED - Yes

Certificate No. 1

\*\* End of Current Title Search \*\*

COPYRIGHT THE STATE OF QUEENSLAND (DEPT OF NATURAL RESOURCES AND MINES) [2014]  
Requested By: SMIS .

# CURRENT TITLE SEARCH

DEPT OF NATURAL RESOURCES AND MINES, QUEENSLAND

Request No: 19900804

Search Date: 01/12/2014 09:23

Title Reference: 12380011

Date Created: 06/02/1948

Previous Title: 11880044

## REGISTERED OWNER

THE UNIVERSITY OF QUEENSLAND

## ESTATE AND LAND

Estate in Fee Simple

LOT 311 REGISTERED PLAN 40784

County of STANLEY

Parish of INDOOROOPIILLY

Local Government: BRISBANE CITY

## EASEMENTS, ENCUMBRANCES AND INTERESTS

1. Rights and interests reserved to the Crown by  
Deed of Grant No. 19509228 (POR 19)

ADMINISTRATIVE ADVICES - NIL

UNREGISTERED DEALINGS - NIL

CERTIFICATE OF TITLE ISSUED - Yes

Certificate No. 1

\*\* End of Current Title Search \*\*

COPYRIGHT THE STATE OF QUEENSLAND (DEPT OF NATURAL RESOURCES AND MINES) [2014]  
Requested By: SMIS .

# CURRENT TITLE SEARCH

DEPT OF NATURAL RESOURCES AND MINES, QUEENSLAND

Request No: 19900813

Search Date: 01/12/2014 09:23

Title Reference: 12062223

Date Created: 31/01/1939

Previous Title: 10886020

## REGISTERED OWNER

Dealing No: 711424854 14/02/2008

THE UNIVERSITY OF QUEENSLAND

## ESTATE AND LAND

Estate in Fee Simple

LOT 312 REGISTERED PLAN 40784

County of STANLEY

Parish of INDOOROOPILLY

Local Government: BRISBANE CITY

## EASEMENTS, ENCUMBRANCES AND INTERESTS

1. Rights and interests reserved to the Crown by  
Deed of Grant No. 19509228 (POR 19)

ADMINISTRATIVE ADVICES - NIL

UNREGISTERED DEALINGS - NIL

CERTIFICATE OF TITLE ISSUED - No

\*\* End of Current Title Search \*\*

COPYRIGHT THE STATE OF QUEENSLAND (DEPT OF NATURAL RESOURCES AND MINES) [2014]  
Requested By: SMIS .

# CURRENT TITLE SEARCH

DEPT OF NATURAL RESOURCES AND MINES, QUEENSLAND

Request No: 19900819

Search Date: 01/12/2014 09:23

Title Reference: 12483102

Date Created: 08/03/1950

Previous Title: 11853212

## REGISTERED OWNER

Dealing No: 711424854 14/02/2008

THE UNIVERSITY OF QUEENSLAND

## ESTATE AND LAND

Estate in Fee Simple

LOT 313 REGISTERED PLAN 40784

County of STANLEY

Parish of INDOOROOPIILLY

Local Government: BRISBANE CITY

## EASEMENTS, ENCUMBRANCES AND INTERESTS

1. Rights and interests reserved to the Crown by  
Deed of Grant No. 19509228 (POR 19)

ADMINISTRATIVE ADVICES - NIL

UNREGISTERED DEALINGS - NIL

CERTIFICATE OF TITLE ISSUED - No

\*\* End of Current Title Search \*\*

COPYRIGHT THE STATE OF QUEENSLAND (DEPT OF NATURAL RESOURCES AND MINES) [2014]  
Requested By: SMIS .

# CURRENT TITLE SEARCH

DEPT OF NATURAL RESOURCES AND MINES, QUEENSLAND

Request No: 19900860

Search Date: 01/12/2014 09:25

Title Reference: 14198125

Date Created: 05/08/1968

Previous Title: 11856168

## REGISTERED OWNER

THE UNIVERSITY OF QUEENSLAND

## ESTATE AND LAND

Estate in Fee Simple

LOT 317 REGISTERED PLAN 85576

County of STANLEY

Parish of INDOOROOPIILLY

Local Government: BRISBANE CITY

## EASEMENTS, ENCUMBRANCES AND INTERESTS

1. Rights and interests reserved to the Crown by  
Deed of Grant No. 19509228 (POR 19)

ADMINISTRATIVE ADVICES - NIL

UNREGISTERED DEALINGS - NIL

CERTIFICATE OF TITLE ISSUED - Yes

Certificate No. 1

\*\* End of Current Title Search \*\*

COPYRIGHT THE STATE OF QUEENSLAND (DEPT OF NATURAL RESOURCES AND MINES) [2014]  
Requested By: SMIS .



# CURRENT TITLE SEARCH

DEPT OF NATURAL RESOURCES AND MINES, QUEENSLAND

Request No: 19900961

Search Date: 01/12/2014 09:30

Title Reference: 12793180

Date Created: 04/12/1953

Previous Title: 12294094

## REGISTERED OWNER

Dealing No: 704233563 04/08/2000

THE UNIVERSITY OF QUEENSLAND

## ESTATE AND LAND

Estate in Fee Simple

LOT 318 REGISTERED PLAN 40785

County of STANLEY

Parish of INDOOROOPIILLY

Local Government: BRISBANE CITY

## EASEMENTS, ENCUMBRANCES AND INTERESTS

1. Rights and interests reserved to the Crown by  
Deed of Grant No. 19509228 (POR 19)

ADMINISTRATIVE ADVICES - NIL

UNREGISTERED DEALINGS - NIL

CERTIFICATE OF TITLE ISSUED - No

\*\* End of Current Title Search \*\*

COPYRIGHT THE STATE OF QUEENSLAND (DEPT OF NATURAL RESOURCES AND MINES) [2014]  
Requested By: SMIS .

# CURRENT TITLE SEARCH

DEPT OF NATURAL RESOURCES AND MINES, QUEENSLAND

Request No: 19900972

Search Date: 01/12/2014 09:30

Title Reference: 12784241

Date Created: 23/10/1953

Previous Title: 12294094

## REGISTERED OWNER

THE UNIVERSITY OF QUEENSLAND

## ESTATE AND LAND

Estate in Fee Simple

LOT 319 REGISTERED PLAN 40785

County of STANLEY

Parish of INDOOROOPIILLY

Local Government: BRISBANE CITY

## EASEMENTS, ENCUMBRANCES AND INTERESTS

1. Rights and interests reserved to the Crown by  
Deed of Grant No. 11601058 (POR 18)  
Deed of Grant No. 19509228 (POR 19)

ADMINISTRATIVE ADVICES - NIL

UNREGISTERED DEALINGS - NIL

CERTIFICATE OF TITLE ISSUED - Yes

Certificate No. 1

\*\* End of Current Title Search \*\*

COPYRIGHT THE STATE OF QUEENSLAND (DEPT OF NATURAL RESOURCES AND MINES) [2014]

Requested By: SMIS .

# CURRENT TITLE SEARCH

DEPT OF NATURAL RESOURCES AND MINES, QUEENSLAND

Request No: 19901015

Search Date: 01/12/2014 09:33

Title Reference: 50849639

Date Created: 17/06/2011

Previous Title: 50550079

## REGISTERED OWNER

Dealing No: 714615820 10/08/2012

THE STATE OF QUEENSLAND

(REPRESENTED BY DEPARTMENT OF NATURAL RESOURCES AND MINES)

## ESTATE AND LAND

Estate in Fee Simple

LOT 298 SURVEY PLAN 228363

County of STANLEY Parish of INDOOROOPILLY

Local Government: BRISBANE CITY

## EASEMENTS, ENCUMBRANCES AND INTERESTS

1. Rights and interests reserved to the Crown by  
Deed of Grant No. 40046990 (Lot 297 on CP SL12778)
2. LEASE No 715135200 12/06/2013 at 13:34  
THE UNIVERSITY OF QUEENSLAND A.B.N. 63 942 912 684  
OF THE WHOLE OF THE LAND  
TERM: 24/05/2013 TO 23/05/2112 OPTION NIL
3. AMENDMENT OF LEASE No 716106709 29/10/2014 at 15:17  
LEASE: 715135200  
TERM: 24/05/2013 TO 23/05/2112 OPTION NIL

ADMINISTRATIVE ADVICES - NIL

UNREGISTERED DEALINGS - NIL

CERTIFICATE OF TITLE ISSUED - No

Caution - Charges do not necessarily appear in order of priority

\*\* End of Current Title Search \*\*

COPYRIGHT THE STATE OF QUEENSLAND (DEPT OF NATURAL RESOURCES AND MINES) [2014]

Requested By: SMIS .

# CURRENT TITLE SEARCH

DEPT OF NATURAL RESOURCES AND MINES, QUEENSLAND

Request No: 19900996

Search Date: 01/12/2014 09:31

Title Reference: 50550078

Date Created: 15/04/2005

Previous Title: 40046987

## REGISTERED OWNER

Dealing No: 714615820 10/08/2012

THE STATE OF QUEENSLAND

(REPRESENTED BY DEPARTMENT OF NATURAL RESOURCES AND MINES)

## ESTATE AND LAND

Estate in Fee Simple

LOT 332 CROWN PLAN SL12778

County of STANLEY

Parish of INDOOROOPILLY

Local Government: BRISBANE CITY

## EASEMENTS, ENCUMBRANCES AND INTERESTS

1. Rights and interests reserved to the Crown by  
Deed of Grant No. 40046987 (Lot 332 on CP SL12778)
2. LEASE No 715135200 12/06/2013 at 13:34  
THE UNIVERSITY OF QUEENSLAND A.B.N. 63 942 912 684  
OF THE WHOLE OF THE LAND  
TERM: 24/05/2013 TO 23/05/2112 OPTION NIL
3. AMENDMENT OF LEASE No 716106709 29/10/2014 at 15:17  
LEASE: 715135200  
TERM: 24/05/2013 TO 23/05/2112 OPTION NIL

ADMINISTRATIVE ADVICES - NIL

UNREGISTERED DEALINGS - NIL

CERTIFICATE OF TITLE ISSUED - No

Caution - Charges do not necessarily appear in order of priority

\*\* End of Current Title Search \*\*

COPYRIGHT THE STATE OF QUEENSLAND (DEPT OF NATURAL RESOURCES AND MINES) [2014]

Requested By: SMIS .

# CURRENT TITLE SEARCH

DEPT OF NATURAL RESOURCES AND MINES, QUEENSLAND

Request No: 19901009

Search Date: 01/12/2014 09:32

Title Reference: 50827693

Date Created: 22/10/2010

Previous Title: 40061105

## REGISTERED OWNER

Dealing No: 714615820 10/08/2012

THE STATE OF QUEENSLAND

(REPRESENTED BY DEPARTMENT OF NATURAL RESOURCES AND MINES)

## ESTATE AND LAND

Estate in Fee Simple

LOT 350 CROWN PLAN SL5279

County of STANLEY Parish of INDOOROOPILLY

Local Government: BRISBANE CITY

## EASEMENTS, ENCUMBRANCES AND INTERESTS

1. Rights and interests reserved to the Crown by  
Deed of Grant No. 40061105 (Lot 350 on CP SL5279)
2. LEASE No 715135200 12/06/2013 at 13:34  
THE UNIVERSITY OF QUEENSLAND A.B.N. 63 942 912 684  
OF THE WHOLE OF THE LAND  
TERM: 24/05/2013 TO 23/05/2112 OPTION NIL
3. AMENDMENT OF LEASE No 716106709 29/10/2014 at 15:17  
LEASE: 715135200  
TERM: 24/05/2013 TO 23/05/2112 OPTION NIL

ADMINISTRATIVE ADVICES - NIL

UNREGISTERED DEALINGS - NIL

CERTIFICATE OF TITLE ISSUED - No

Caution - Charges do not necessarily appear in order of priority

\*\* End of Current Title Search \*\*

COPYRIGHT THE STATE OF QUEENSLAND (DEPT OF NATURAL RESOURCES AND MINES) [2014]

Requested By: SMIS .

# CURRENT TITLE SEARCH

DEPT OF NATURAL RESOURCES AND MINES, QUEENSLAND

Request No: 19901275

Search Date: 01/12/2014 09:46

Title Reference: 12930019

Date Created: 03/11/1955

Previous Title: 12864038

## REGISTERED OWNER

THE UNIVERSITY OF QUEENSLAND

## ESTATE AND LAND

Estate in Fee Simple

LOT 1 REGISTERED PLAN 77354  
County of STANLEY Parish of INDOOROOPIILLY  
Local Government: BRISBANE CITY

## EASEMENTS, ENCUMBRANCES AND INTERESTS

1. Rights and interests reserved to the Crown by  
Deed of Grant No. 19506141 (POR 12)
2. LEASE No 601850839 (E959838) 12/06/1975  
OF THE WHOLE OF THE LAND  
TO DESMOND FRANCIS DOWLING  
ORIGINAL TERM: COMMENCING 23 MAY 1975  
TERMINATING 31 DEC 1983  
OR OPTIONS AS MAY BE STATED

ADMINISTRATIVE ADVICES - NIL

UNREGISTERED DEALINGS - NIL

CERTIFICATE OF TITLE ISSUED - Yes

Certificate No. 1

Caution - Charges do not necessarily appear in order of priority

\*\* End of Current Title Search \*\*

COPYRIGHT THE STATE OF QUEENSLAND (DEPT OF NATURAL RESOURCES AND MINES) [2014]  
Requested By: SMIS .

# CURRENT TITLE SEARCH

DEPT OF NATURAL RESOURCES AND MINES, QUEENSLAND

Request No: 19901655

Search Date: 01/12/2014 10:04

Title Reference: 12699143

Date Created: 12/11/1952

Previous Title: 12489007

## REGISTERED OWNER

THE UNIVERSITY OF QUEENSLAND

## ESTATE AND LAND

Estate in Fee Simple

LOT 1 REGISTERED PLAN 68981  
County of STANLEY Parish of INDOOROOPIILLY  
Local Government: BRISBANE CITY

## EASEMENTS, ENCUMBRANCES AND INTERESTS

1. Rights and interests reserved to the Crown by  
Deed of Grant No. 19506142 (POR 11)

ADMINISTRATIVE ADVICES - NIL

UNREGISTERED DEALINGS - NIL

CERTIFICATE OF TITLE ISSUED - Yes

Certificate No. 1

\*\* End of Current Title Search \*\*

COPYRIGHT THE STATE OF QUEENSLAND (DEPT OF NATURAL RESOURCES AND MINES) [2014]  
Requested By: SMIS .

# CURRENT TITLE SEARCH

DEPT OF NATURAL RESOURCES AND MINES, QUEENSLAND

Request No: 19901641  
Search Date: 01/12/2014 10:03

Title Reference: 13469097  
Date Created: 09/03/1962

Previous Title: 13224029

## REGISTERED OWNER

THE UNIVERSITY OF QUEENSLAND

## ESTATE AND LAND

Estate in Fee Simple

LOT 1 REGISTERED PLAN 98467  
County of STANLEY Parish of INDOOROOPILLY  
Local Government: BRISBANE CITY

## EASEMENTS, ENCUMBRANCES AND INTERESTS

1. Rights and interests reserved to the Crown by  
Deed of Grant No. 19506141 (POR 12)
2. LEASE No 704792762 30/05/2001 at 09:20  
COMMONWEALTH SCIENTIFIC AND INDUSTRIAL RESEARCH ORGANISATION  
  
OF PARTS OF LEVELS 1,2,3 AND 4
3. EASEMENT IN GROSS No 707443464 04/02/2004 at 11:26  
burdening the land  
BRISBANE CITY COUNCIL  
over  
EASEMENT A ON SP139437
4. LEASE No 709493374 04/04/2006 at 15:03  
COMMONWEALTH SCIENTIFIC AND INDUSTRIAL RESEARCH ORGANISATION  
OF PART OF LEVEL 1 (LEASE 7 & 7A),  
OF PART OF LEVEL 2 (LEASE 19),  
OF PART OF LEVEL 3 (LEASE 24, 25 & 26)  
OF PART OF LEVEL 4 (LEASE 31)  
OF PART OF LEVEL 5 (LEASE 36 & 37)  
OF PART OF LEVEL 6 (LEASE 42)  
OF PART OF LEVEL 7 (LEASE 48 & 49) &  
OF PART OF LEVEL 8 (LEASE 50) AND  
OF PART OF THE BASEMENT FLOOR (LEASE A)  
OF PART OF THE GROUND FLOOR (LEASE B)  
OF PART OF THE FIRST FLOOR (LEASE C) AND  
PART OF THE SECOND FLOOR (LEASE D)  
TERM: 28/02/2003 TO 27/02/2102 OPTION NIL

ADMINISTRATIVE ADVICES - NIL  
UNREGISTERED DEALINGS - NIL

CERTIFICATE OF TITLE ISSUED - No



# CURRENT TITLE SEARCH

DEPT OF NATURAL RESOURCES AND MINES, QUEENSLAND

Request No: 19901641

Search Date: 01/12/2014 10:03

**Title Reference: 13469097**

Date Created: 09/03/1962

Corrections have occurred - Refer to Historical Search

Caution - Charges do not necessarily appear in order of priority

**\*\* End of Current Title Search \*\***

COPYRIGHT THE STATE OF QUEENSLAND (DEPT OF NATURAL RESOURCES AND MINES) [2014]  
Requested By: SMIS .

# CURRENT TITLE SEARCH

DEPT OF NATURAL RESOURCES AND MINES, QUEENSLAND

Request No: 19901618

Search Date: 01/12/2014 10:02

Title Reference: 50488248

Date Created: 02/04/2004

Previous Title: 14638127

## REGISTERED OWNER

Dealing No: 707612031 01/04/2004

THE UNIVERSITY OF QUEENSLAND

## ESTATE AND LAND

Estate in Fee Simple

LOT 1 SURVEY PLAN 137545  
County of STANLEY Parish of INDOOROOPIILLY  
Local Government: BRISBANE CITY

## EASEMENTS, ENCUMBRANCES AND INTERESTS

1. Rights and interests reserved to the Crown by  
Deed of Grant No. 14291143 (POR 338)

ADMINISTRATIVE ADVICES - NIL

UNREGISTERED DEALINGS - NIL

CERTIFICATE OF TITLE ISSUED - No

\*\* End of Current Title Search \*\*

COPYRIGHT THE STATE OF QUEENSLAND (DEPT OF NATURAL RESOURCES AND MINES) [2014]  
Requested By: SMIS .

# CURRENT TITLE SEARCH

DEPT OF NATURAL RESOURCES AND MINES, QUEENSLAND

Request No: 19901540

Search Date: 01/12/2014 09:58

Title Reference: 12835157

Date Created: 30/06/1954

Previous Title: 10635165

12767044

## REGISTERED OWNER

THE UNIVERSITY OF QUEENSLAND

## ESTATE AND LAND

Estate in Fee Simple

LOT 2 REGISTERED PLAN 77354

County of STANLEY

Parish of INDOOROOPIILLY

Local Government: BRISBANE CITY

## EASEMENTS, ENCUMBRANCES AND INTERESTS

1. Rights and interests reserved to the Crown by  
Deed of Grant No. 19506141 (POR 12)

ADMINISTRATIVE ADVICES - NIL

UNREGISTERED DEALINGS - NIL

CERTIFICATE OF TITLE ISSUED - Yes

Certificate No. 1

\*\* End of Current Title Search \*\*

COPYRIGHT THE STATE OF QUEENSLAND (DEPT OF NATURAL RESOURCES AND MINES) [2014]

Requested By: SMIS .

# CURRENT TITLE SEARCH

DEPT OF NATURAL RESOURCES AND MINES, QUEENSLAND

Request No: 19901649

Search Date: 01/12/2014 10:03

Title Reference: 13693242

Date Created: 26/08/1964

Previous Title: 12678036  
12685215  
12891089

## REGISTERED OWNER

THE UNIVERSITY OF QUEENSLAND

## ESTATE AND LAND

Estate in Fee Simple

LOT 2 REGISTERED PLAN 96392  
County of STANLEY Parish of INDOOROOPILLY  
Local Government: BRISBANE CITY

## EASEMENTS, ENCUMBRANCES AND INTERESTS

1. Rights and interests reserved to the Crown by  
Deed of Grant No. 19506141 (POR 12)
2. EASEMENT IN GROSS No 707443464 04/02/2004 at 11:26  
burdening the land  
BRISBANE CITY COUNCIL  
over  
EASEMENT B ON SP139437
3. EASEMENT IN GROSS No 707443478 04/02/2004 at 11:28  
burdening the land  
ENERGEX LIMITED A.C.N. 078 849 055  
over  
EASEMENT G ON SP139437
4. LEASE No 709493374 04/04/2006 at 15:03  
COMMONWEALTH SCIENTIFIC AND INDUSTRIAL RESEARCH ORGANISATION  
OF PART OF THE BASEMENT FLOOR (LEASE A)  
OF PART OF THE GROUND FLOOR (LEASE B)  
OF PART OF THE FIRST FLOOR (LEASE C) AND  
PART OF THE SECOND FLOOR (LEASE D)  
TERM: 28/02/2003 TO 27/02/2102 OPTION NIL

ADMINISTRATIVE ADVICES - NIL

UNREGISTERED DEALINGS - NIL

## CERTIFICATE OF TITLE ISSUED - No

Corrections have occurred - Refer to Historical Search

Caution - Charges do not necessarily appear in order of priority

\*\* End of Current Title Search \*\*

COPYRIGHT THE STATE OF QUEENSLAND (DEPT OF NATURAL RESOURCES AND MINES) [2014]  
Requested By: SMIS .

# CURRENT TITLE SEARCH

DEPT OF NATURAL RESOURCES AND MINES, QUEENSLAND

Request No: 19901612

Search Date: 01/12/2014 10:01

Title Reference: 50488249

Date Created: 02/04/2004

Previous Title: 14638127

## REGISTERED OWNER

Dealing No: 707612031 01/04/2004

THE UNIVERSITY OF QUEENSLAND

## ESTATE AND LAND

Estate in Fee Simple

LOT 2 SURVEY PLAN 137545

County of STANLEY

Parish of INDOOROOPIILLY

Local Government: BRISBANE CITY

## EASEMENTS, ENCUMBRANCES AND INTERESTS

1. Rights and interests reserved to the Crown by  
Deed of Grant No. 14291143 (POR 338)

ADMINISTRATIVE ADVICES - NIL

UNREGISTERED DEALINGS - NIL

CERTIFICATE OF TITLE ISSUED - No

\*\* End of Current Title Search \*\*

COPYRIGHT THE STATE OF QUEENSLAND (DEPT OF NATURAL RESOURCES AND MINES) [2014]  
Requested By: SMIS .

# CURRENT TITLE SEARCH

DEPT OF NATURAL RESOURCES AND MINES, QUEENSLAND

Request No: 19901627

Search Date: 01/12/2014 10:02

Title Reference: 12835156

Date Created: 30/06/1954

Previous Title: 10664099

## REGISTERED OWNER

THE UNIVERSITY OF QUEENSLAND

## ESTATE AND LAND

Estate in Fee Simple

LOT 3 REGISTERED PLAN 77354

County of STANLEY

Parish of INDOOROOPIILLY

Local Government: BRISBANE CITY

## EASEMENTS, ENCUMBRANCES AND INTERESTS

1. Rights and interests reserved to the Crown by  
Deed of Grant No. 19506141 (POR 12)

ADMINISTRATIVE ADVICES - NIL

UNREGISTERED DEALINGS - NIL

CERTIFICATE OF TITLE ISSUED - Yes

Certificate No. 1

\*\* End of Current Title Search \*\*

COPYRIGHT THE STATE OF QUEENSLAND (DEPT OF NATURAL RESOURCES AND MINES) [2014]  
Requested By: SMIS .

# CURRENT TITLE SEARCH

DEPT OF NATURAL RESOURCES AND MINES, QUEENSLAND

Request No: 19901636

Search Date: 01/12/2014 10:02

Title Reference: 12938061

Date Created: 30/11/1955

Previous Title: 12864038

## REGISTERED OWNER

THE UNIVERSITY OF QUEENSLAND

## ESTATE AND LAND

Estate in Fee Simple

LOT 4 REGISTERED PLAN 77354

County of STANLEY

Parish of INDOOROOPIILLY

Local Government: BRISBANE CITY

## EASEMENTS, ENCUMBRANCES AND INTERESTS

1. Rights and interests reserved to the Crown by  
Deed of Grant No. 19506141 (POR 12)

ADMINISTRATIVE ADVICES - NIL

UNREGISTERED DEALINGS - NIL

CERTIFICATE OF TITLE ISSUED - Yes

Certificate No. 1

\*\* End of Current Title Search \*\*

COPYRIGHT THE STATE OF QUEENSLAND (DEPT OF NATURAL RESOURCES AND MINES) [2014]  
Requested By: SMIS .

# CURRENT STATE TENURE SEARCH

DEPT OF NATURAL RESOURCES AND MINES, QUEENSLAND

Request No: 19901267

Search Date: 01/12/2014 09:46

Title Reference: 40058877

Date Created: 22/07/2009

## DESCRIPTION OF LAND

Tenure Reference: TL 0/233488

Lease Type: TERM

LOT 100 SURVEY PLAN 147392  
County of STANLEY Parish of INDOOROOPILLY  
Local Government: BRISBANE CITY

Area: 0.215900 Ha. (SURVEYED)

No Land Description

No Forestry Entitlement Area

No Future Conservation Area

Purpose for which granted:  
COMMERCIAL/BUSINESS

## TERM OF LEASE

Term and day of beginning of lease

Term: 30 years commencing on 08/07/2009

Expiring on 07/07/2039

## REGISTERED LESSEE

THE UNIVERSITY OF QUEENSLAND

## CONDITIONS



# CURRENT STATE TENURE SEARCH

DEPT OF NATURAL RESOURCES AND MINES, QUEENSLAND

Request No: 19901267

Search Date: 01/12/2014 09:46

Title Reference: 40058877

Date Created: 22/07/2009

## CONDITIONS

- A78
- (1) The lessee must use the leased land for education purposes namely carparking, housing existing greenhouses and basketball courts.
  - (2) This lease may be forfeited if not used for the purpose stated above.
  - (3) The annual rent must be paid in accordance with the Land Act 1994.
  - (4) The Parties acknowledge that GST may be payable in respect of a supply made under this lease. Where GST becomes payable in respect of a supply made under this lease, the State (lessor) may recover the GST from the lessee by increasing the consideration payable by the lessee to the State by an amount equal to that which the State is obliged to remit to the Commonwealth as GST on the supply and that amount may be recovered from the lessee as part of the money payable to the State under this lease. The State will upon request by the lessee, issue to the lessee a valid GST tax invoice in respect of any taxable supply made under this lease. (NOTE: For the purposes of this condition "GST" means the goods and services tax which results from the enactment of A New Tax System (Goods and Services Tax) Act 1999 and the related Acts which constitute the Commonwealth taxation reform (as amended from time to time)).
  - (5) The lessee must pay the cost of any required survey or re-survey of the leased land.
  - (6) The lessee must control pest plants and animals, on the leased land, in accordance with the Land Protection (Pest and Stock Route Management) Act 2002 and the Local Laws and requirements of the Brisbane City Council.
  - (7) The lessee has the responsibility for a duty of care, to take all reasonable and practicable measures to sustainably manage the leased land by conserving the physical, biological, productive and cultural values, either on the leased land or in areas affected by the management of the leased land.
  - (8) The lessee must ensure that the use and development of the leased land conforms to the Planning Scheme, Local Laws and requirements of the Brisbane City Council, binding on the lessee.
  - (9) The lessee must give the Minister administering the Land Act 1994, information about the lease, when requested.
  - (10) The lessee must not clear any vegetation on the leased land, unless in accordance with the Integrated Planning Act 1997.
  - (11) No compensation for improvements or developmental work is payable by the State at the forfeiture, surrender or expiry of the lease, but the lessee has the right to remove the lessees moveable improvements within a period of three (3) months from the forfeiture, surrender or expiry of the lease, provided all money due by the lessee to the State on any account whatsoever has been paid, or be required to remove those improvements as specified in any further condition of lease.
  - (12) This lease is subject to the Land Act 1994 and all other relevant State and Commonwealth Acts.

# CURRENT STATE TENURE SEARCH

DEPT OF NATURAL RESOURCES AND MINES, QUEENSLAND

Request No: 19901267

Search Date: 01/12/2014 09:46

Title Reference: 40058877

Date Created: 22/07/2009

## CONDITIONS

I66 The lessee indemnifies and agrees to keep indemnified the Minister administering the Land Act 1994, and the State of Queensland, (the "Indemnified parties") against all actions, suits, proceedings, claims, demands, costs, losses, damages and expenses ("Claim") arising out of or in any way connected to or resulting from the granting of this lease to the lessee or which is connected to or resulting from the lessees' use and occupation of the leased land (all of which are referred to as "the indemnified acts or omissions") save to the extent that the Claim arises as a result of any negligent act or omission of the Indemnified parties, however, any negligent act or omission of one of the Indemnified parties does not negate the indemnity to any of the other Indemnified party/ies. The lessee hereby releases and discharges the Indemnified parties from any Claim relating to the indemnified acts or omissions which may be made against the Indemnified parties.

## ENCUMBRANCES AND INTERESTS

1. Rights and interests reserved to the Crown by Lease No. 40058877
2. COVENANT No 712943994 17/12/2009 at 13:35 restricts dealings over LOT 367 ON CROWN PLAN SL5786 AND LOT 100 ON SP147392

ADMINISTRATIVE ADVICES - NIL

UNREGISTERED DEALINGS - NIL

Caution - Charges do not necessarily appear in order of priority

\*\* End of Current State Tenure Search \*\*

Information provided under section 34 Land Title Act(1994) or section 281 Land Act(1994)

COPYRIGHT THE STATE OF QUEENSLAND (DEPT OF NATURAL RESOURCES AND MINES) [2014]  
Requested By: SMIS .

# CURRENT TITLE SEARCH

DEPT OF NATURAL RESOURCES AND MINES, QUEENSLAND

Request No: 19901667

Search Date: 01/12/2014 10:04

Title Reference: 15941096

Date Created: 23/11/1979

Previous Title: 12780037

12848083

## REGISTERED OWNER

THE UNIVERSITY OF QUEENSLAND

## ESTATE AND LAND

Estate in Fee Simple

LOT 151 REGISTERED PLAN 166895

County of STANLEY

Parish of INDOOROOPILLY

Local Government: BRISBANE CITY

## EASEMENTS, ENCUMBRANCES AND INTERESTS

1. Rights and interests reserved to the Crown by  
Deed of Grant No. 19506142 (POR 11)

ADMINISTRATIVE ADVICES - NIL

UNREGISTERED DEALINGS - NIL

CERTIFICATE OF TITLE ISSUED - Yes

Certificate No. 1

\*\* End of Current Title Search \*\*

COPYRIGHT THE STATE OF QUEENSLAND (DEPT OF NATURAL RESOURCES AND MINES) [2014]

Requested By: SMIS .

# CURRENT TITLE SEARCH

DEPT OF NATURAL RESOURCES AND MINES, QUEENSLAND

Request No: 19901674

Search Date: 01/12/2014 10:04

Title Reference: 15941097

Date Created: 23/11/1979

Previous Title: 12948048

## REGISTERED OWNER

THE UNIVERSITY OF QUEENSLAND

## ESTATE AND LAND

Estate in Fee Simple

LOT 152 REGISTERED PLAN 166895

County of STANLEY Parish of INDOOROOPILLY

Local Government: BRISBANE CITY

## EASEMENTS, ENCUMBRANCES AND INTERESTS

1. Rights and interests reserved to the Crown by  
Deed of Grant No. 19506142 (POR 11)

ADMINISTRATIVE ADVICES - NIL

UNREGISTERED DEALINGS - NIL

CERTIFICATE OF TITLE ISSUED - Yes

Certificate No. 1

\*\* End of Current Title Search \*\*

COPYRIGHT THE STATE OF QUEENSLAND (DEPT OF NATURAL RESOURCES AND MINES) [2014]  
Requested By: SMIS .

# CURRENT TITLE SEARCH

DEPT OF NATURAL RESOURCES AND MINES, QUEENSLAND

Request No: 19901240

Search Date: 01/12/2014 09:44

Title Reference: 14578128

Date Created: 11/05/1971

## REGISTERED OWNER

THE UNIVERSITY OF QUEENSLAND

## ESTATE AND LAND

Estate in Fee Simple

LOT 335 CROWN PLAN SL3987

County of STANLEY

Parish of INDOOROOPILLY

Local Government: BRISBANE CITY

## EASEMENTS, ENCUMBRANCES AND INTERESTS

1. Rights and interests reserved to the Crown by  
Deed of Grant No. 13509083 (POR 335)

ADMINISTRATIVE ADVICES - NIL

UNREGISTERED DEALINGS - NIL

CERTIFICATE OF TITLE ISSUED - Yes

Certificate No. 1

\*\* End of Current Title Search \*\*

COPYRIGHT THE STATE OF QUEENSLAND (DEPT OF NATURAL RESOURCES AND MINES) [2014]

Requested By: SMIS .

# CURRENT TITLE SEARCH

DEPT OF NATURAL RESOURCES AND MINES, QUEENSLAND

Request No: 19901246

Search Date: 01/12/2014 09:44

Title Reference: 14291144

Date Created: 09/05/1969

## REGISTERED OWNER

THE UNIVERSITY OF QUEENSLAND

## ESTATE AND LAND

Estate in Fee Simple

LOT 357 CROWN PLAN SL5543

County of STANLEY

Parish of INDOOROOPILLY

Local Government: BRISBANE CITY

## EASEMENTS, ENCUMBRANCES AND INTERESTS

1. Rights and interests reserved to the Crown by  
Deed of Grant No. 14291144 (POR 357)

ADMINISTRATIVE ADVICES - NIL

UNREGISTERED DEALINGS - NIL

CERTIFICATE OF TITLE ISSUED - Yes

Certificate No. 1

\*\* End of Current Title Search \*\*

COPYRIGHT THE STATE OF QUEENSLAND (DEPT OF NATURAL RESOURCES AND MINES) [2014]

Requested By: SMIS .

# CURRENT TITLE SEARCH

DEPT OF NATURAL RESOURCES AND MINES, QUEENSLAND

Request No: 19901252

Search Date: 01/12/2014 09:45

Title Reference: 14291145

Date Created: 09/05/1969

## REGISTERED OWNER

THE UNIVERSITY OF QUEENSLAND

## ESTATE AND LAND

Estate in Fee Simple

LOT 367 CROWN PLAN SL5786  
County of STANLEY Parish of INDOOROOPIILLY  
Local Government: BRISBANE CITY

## EASEMENTS, ENCUMBRANCES AND INTERESTS

1. Rights and interests reserved to the Crown by  
Deed of Grant No. 14291145 (POR 367)
2. COVENANT No 712943994 17/12/2009 at 13:35  
restricts dealings over  
LOT 367 ON CROWN PLAN SL5786 AND  
LOT 100 ON SP147392

ADMINISTRATIVE ADVICES - NIL

UNREGISTERED DEALINGS - NIL

CERTIFICATE OF TITLE ISSUED - No

Caution - Charges do not necessarily appear in order of priority

\*\* End of Current Title Search \*\*

COPYRIGHT THE STATE OF QUEENSLAND (DEPT OF NATURAL RESOURCES AND MINES) [2014]  
Requested By: SMIS .

# CURRENT TITLE SEARCH

DEPT OF NATURAL RESOURCES AND MINES, QUEENSLAND

Request No: 19901030

Search Date: 01/12/2014 09:33

Title Reference: 16963082

Date Created: 20/10/1986

Previous Title: 14803196

## REGISTERED OWNER

THE UNIVERSITY OF QUEENSLAND

## ESTATE AND LAND

Estate in Fee Simple

LOT 382 CROWN PLAN SL6788  
County of STANLEY Parish of INDOOROOPIILLY  
Local Government: BRISBANE CITY

## EASEMENTS, ENCUMBRANCES AND INTERESTS

1. Rights and interests reserved to the Crown by  
Deed of Grant No. 11758105 (POR 249)  
Deed of Grant No. 11758106 (POR 250)  
Deed of Grant No. 19506135 (POR 18)  
Deed of Grant No. 19506136 (POR 17)  
Deed of Grant No. 19506137 (POR 16)  
Deed of Grant No. 19506138 (POR 15)  
Deed of Grant No. 19506139 (POR 14)  
Deed of Grant No. 19506140 (POR 13)  
Deed of Grant No. 19509228 (POR 19)
2. EASEMENT No 601792708 (D597498) 06/06/1968  
BURDENING THE LAND  
TO RESUB 2 OF SUBS 1 AND 2 OF POR 16  
OVER EASEMENT A ON RP113965
3. EASEMENT No 601792710 (D597499) 06/06/1968  
BURDENING THE LAND  
TO RESUBS 34 TO 36, 68 TO 78, 111 TO 114 AND SUB 3 OF RESUBS  
30 TO 33, 37, 67, 79 AND 110 OF SUB 2 OF POR 17 AND OF SUB 1  
OF POR 16 AND OF POR 250  
OVER EASEMENT A ON RP113965
4. EASEMENT No 601819795 (D597496) 06/06/1968  
BURDENING THE LAND  
TO SUBS 38, 39, 61 TO 66, 80 TO 89, 98 TO 109 AND RESUB 4 OF  
SUBS 37, 40 TO 44, 58 TO 60, 67, 90 TO 92, 96, 97 AND 110 OF  
POR 18 AND OF SUB 2 OF POR 17 AND OF POR 250  
OVER EASEMENT A ON RP113965
5. EASEMENT No 601829989 (D597497) 06/06/1968  
BURDENING THE LAND  
TO RESUB 1 OF SUBS 1 AND 2 OF POR 16  
OVER EASEMENT A ON RP113965



# CURRENT TITLE SEARCH

DEPT OF NATURAL RESOURCES AND MINES, QUEENSLAND

Request No: 19901030

Search Date: 01/12/2014 09:33

Title Reference: 16963082

Date Created: 20/10/1986

## EASEMENTS, ENCUMBRANCES AND INTERESTS

6. EASEMENT No 601254166 (G573114) 23/11/1981  
BURDENING THE LAND  
TO PORS 399 AND 400 AND LOT 1 ON RP149808 AND LOT 1 ON  
RP160213  
OVER EASEMENT C ON RP176164
7. PARTIAL RELEASE No 602435451 (H133589) 21/11/1983  
OF EASEMENT G573114  
SO FAR AS RELATES TO LOTS 1 TO 7, 61 AND 62 ON RP187362,  
LOTS 8 TO 20 ON RP187363 AND LOTS 21 TO 32 ON RP187364
8. PARTIAL RELEASE No 602435452 (H218945) 02/03/1984  
OF EASEMENT G573114  
SO FAR AS RELATES TO LOTS 33 TO 39 ON RP187365, LOTS 40 TO  
48 ON RP187366 AND LOTS 49 TO 60 ON RP187367
9. LEASE No 602435453 (H782314) 23/12/1985  
OF PART OF THE GROUND FLOOR  
TO WESTPAC BANKING CORPORATION  
ORIGINAL TERM: FOR 10 YEARS  
COMMENCING 20 JUN 1984  
OR OPTIONS AS MAY BE STATED
10. LEASE No 602435454 (H881098) 19/05/1986  
OF PART OF THE LOWER GROUND FLOOR  
TO COMMONWEALTH SAVINGS BANK OF AUSTRALIA  
ORIGINAL TERM: FOR 3 YEARS  
COMMENCING 17 SEP 1984  
OR OPTIONS AS MAY BE STATED
11. LEASE No 602435455 (H940832) 12/08/1986  
OF PART OF THE LOWER GROUND FLOOR  
TO AUSTRALIAN POSTAL COMMISSION  
ORIGINAL TERM: FOR 9 YEARS  
COMMENCING 02 AUG 1985  
OR OPTIONS AS MAY BE STATED
12. LEASE No 602435456 (K293404R) 31/05/1990  
OF PART OF THE FIRST FLOOR  
TO NATIONAL AUSTRALIA BANK LIMITED  
ORIGINAL TERM: COMMENCING 11 DEC 1989  
TERMINATING 10 DEC 1999  
OR OPTIONS AS MAY BE STATED
13. LEASE No 703437557 07/07/1999 at 09:41  
COMMONWEALTH BANK OF AUSTRALIA A.C.N. 123 123 124  
OF PART OF LEVEL ONE OF THE JD STOREY BUILDING
14. LEASE No 703948247 22/03/2000 at 09:36  
ANSETT AUSTRALIA LIMITED A.C.N. 004 209 410  
OF PART OF LEVEL ONE OF THE BUILDING.

# CURRENT TITLE SEARCH

DEPT OF NATURAL RESOURCES AND MINES, QUEENSLAND

Request No: 19901030

Search Date: 01/12/2014 09:33

Title Reference: 16963082

Date Created: 20/10/1986

## EASEMENTS, ENCUMBRANCES AND INTERESTS

15. LEASE No 707859377 01/07/2004 at 16:07  
AUSTRALIAN POSTAL CORPORATION  
TERM COMMENCING ON 1/11/03 AND EXPIRING ON 31/10/08  
OPTION 5 YEARS
16. LEASE No 708525799 22/03/2005 at 14:00  
AUSTRALIA AND NEW ZEALAND BANKING GROUP LIMITED A.C.N. 005  
357 522  
OF PART OF LEVEL TWO
17. AMENDMENT OF LEASE No 714523206 21/06/2012 at 12:10  
LEASE: 708525799  
TERM: 16/11/2004 TO 15/11/2014 OPTION NIL
18. AMENDMENT OF LEASE No 716107665 30/10/2014 at 10:48  
LEASE: 708525799  
TERM: 16/11/2004 TO 15/11/2015 OPTION NIL
19. EASEMENT IN GROSS No 713081315 25/02/2010 at 13:38  
burdening the land  
BRISBANE CITY COUNCIL  
over  
EASEMENT Z ON SP206222
20. LEASE No 714109376 13/10/2011 at 09:10  
AUSTRALIAN POSTAL CORPORATION  
OF PART OF LEVEL ONE OF A BUILDING (LEASE P)  
TERM: 01/11/2008 TO 31/10/2013 OPTION NIL
21. EASEMENT IN GROSS No 715379217 22/10/2013 at 08:54  
burdening the land  
ENERGEX LIMITED A.C.N. 078 849 055  
over  
EASEMENT D ON SP254180

## ADMINISTRATIVE ADVICES

Dealing	Type	Lodgement Date	Status
703315620	HERITGE SITE QUEENSLAND HERITAGE ACT 1992	04/05/1999 16:34	CURRENT

UNREGISTERED DEALINGS - NIL

## CERTIFICATE OF TITLE ISSUED - No

Caution - Charges do not necessarily appear in order of priority

\*\* End of Current Title Search \*\*

COPYRIGHT THE STATE OF QUEENSLAND (DEPT OF NATURAL RESOURCES AND MINES) [2014]  
Requested By: SMIS .